

# Babson Elective Abroad: Social Responsibility in Malaysia and Thailand

Course instructor: Jim Hoopes, History and Society

Course administrator: Prof. Stephen Deets, History and Society

Course manager: Ms. Renée Graham, Glavin Office

**GLAVIN OFFICE**  
OF MULTICULTURAL &  
INTERNATIONAL EDUCATION



# Generosity and Compassion in the West

Temper generosity with rationality to do the most good.

Give a man a fish and he eats for a day.  
Teach a man to fish and he eats for a lifetime.

Western and especially  
American ethics:

Consequences are what  
matter – Greatest good  
for the greatest  
number





# Generosity and Kindness in Virtue Ethics

Generosity and Compassion should be practiced because they are good for you, not just for others.

Give a woman a fish and she may help you build a fish farm.





# Generosity and Kindness in Virtue Ethics

Generosity and Compassion should be practiced because they are good for you, not just for others.

We will study business ethics in Asia in Buddhism, Confucianism, and Islam

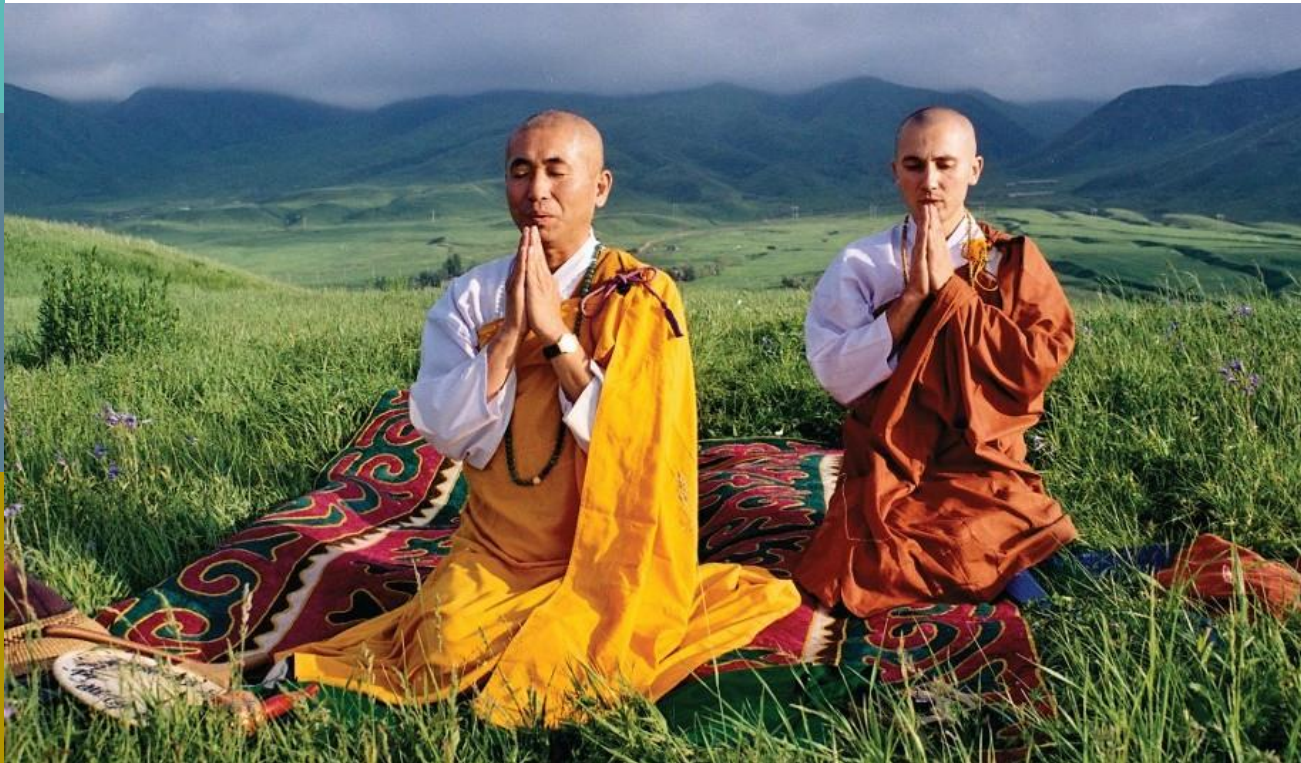



# Buddhism and Business

## Siam Hands





# Buddhism and Education







# Islam and Education



**UNIRAZAK**  
UNIVERSITI TUN ABDUL RAZAK



# Islam and Business





# Confucianism and Business



Glavin Office of Multicultural & International Education



**Legend:**

- Incoming Water flow
- Overflow
- Discharge point

**Site Plan Details:**

- Buildings:** Green House 2 (120' x 30'), Chicken (72' x 50'), Duck (60 x 40), Pig (30' x 20'), Green House Vertical Farming.
- Ponds:** Pond 1, Pond 2, Pond 3, Pond 4, Pond 5.
- Fields:** Padi field 1, Padi field 2, Padi field 3.
- Other:** Maize & Peanut, SUNGAI GOMBAK.

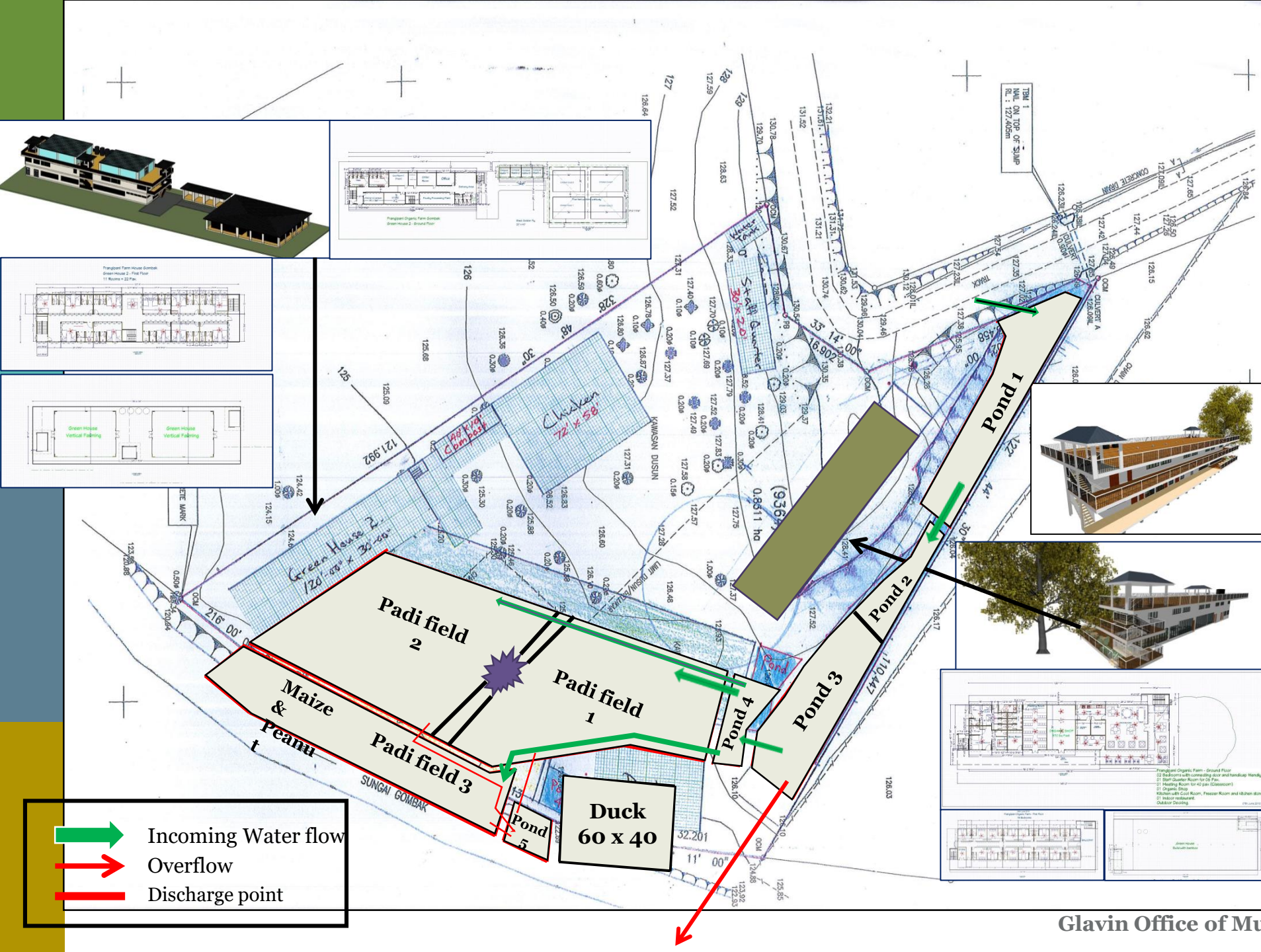

**Legend:**

- Incoming Water flow
- Overflow
- Discharge point

**Site Plan Details:**

- Buildings:** Green House 2 (120' x 30'), Chicken (72' x 50'), Duck (60 x 40), Pig (30' x 20'), Green House Vertical Farming, Green House.
- Ponds:** Pond 1, Pond 2, Pond 3, Pond 4, Pond 5.
- Fields:** Padi field 1, Padi field 2, Padi field 3.
- Other:** Maize & Peanut, SUNGAI GOMBAK, KAWASAN DUSUN, LAKU DUSUN/SEKELUAR DUSUN.

**3D Renderings:**

- Large multi-story building (top left).
- Smaller building (top right).
- Building with ramp (bottom right).



# Are you eligible and what you can expect (coursework/deliverables)

## Pre-Requisites

- RHT1000 Rhetoric I
- RHT1001 Rhetoric II
- AHS1000 AHS Foundation
- One Intermediate (HVA, LVA, CVA)

## Application Notes

- Describe interest in course (including social entrepreneurship, if that is of interest- but not required)
- International Travel Experience (not required, helps gauge balance of course participants)
- Reflection on Global Citizenship
- Personal statement

## Course Deliverables/Grading

- Active/engaged course participation throughout pre departure and travel aspects of course
- Final Paper due following return to Babson



# Social Responsibility in Malaysia and Thailand

## QUICK FACTS:

- **Required attendance at 2 pre-departure meetings:**

Session 1:

Saturday, February 16, 2019

9:30 AM- 1:00 PM

Session 2:

Saturday, March 2, 2019

9:30 AM - 1:00 PM

- **Travel Dates:** Friday, March 15 -24, 2019  
*(Course dates: Sunday, March 17-Saturday, March 23, 2019)*
- **Locations of travel:** Bangkok, Thailand  
Mahidol University, Nakhon Sawan, Thailand  
Kuala Lumpur, Malaysia
- **Additional information including program costs can be found at :**  
[EducationAbroad@Babson.edu](mailto:EducationAbroad@Babson.edu)



# Additional Courses Offered by the Glavin Office of Multicultural & International Education

**Renée Graham**

Assistant Director, Short-Term Programs



# BABSON ELECTIVES ABROAD

Short-term, faculty-led courses • Advanced Liberal Arts and Advanced Electives (4 credits)  
1-3 weeks abroad • No min. GPA

## Fall Semester

- **HUM:** Postmodernism: Future Culture (Dubai)

## Winter Session

- **LIT:** Play, Performance, Politics: The London Stage (United Kingdom)
- **EPS:** Culture & Opportunities in Japan

## Spring Semester

- **ECN:** Regional Economies—Prospects and Tensions in Latin America's S. Cone (Uruguay & Argentina)
- **HIS:** Social Responsibility in Malaysia & Thailand

## Summer 1<sup>st</sup> Session

- **MOB:** Start-up Strategy in Israel
- **HUM:** Mapping Cultural Histories in Spain
- **HIS:** *Crossroads Manhattan (Manhattan, USA)*



# INTERNATIONAL CONSULTING EXPERIENCE

## Earn academic credit through consulting for an international company sponsor

Sophomore, Junior, or Senior • 4-credit Advanced Elective

Spring Semester 2019 • Travel over Winter Break to Lisbon, Portugal

Completion of or Fall 2018 enrollment in ASM 3300

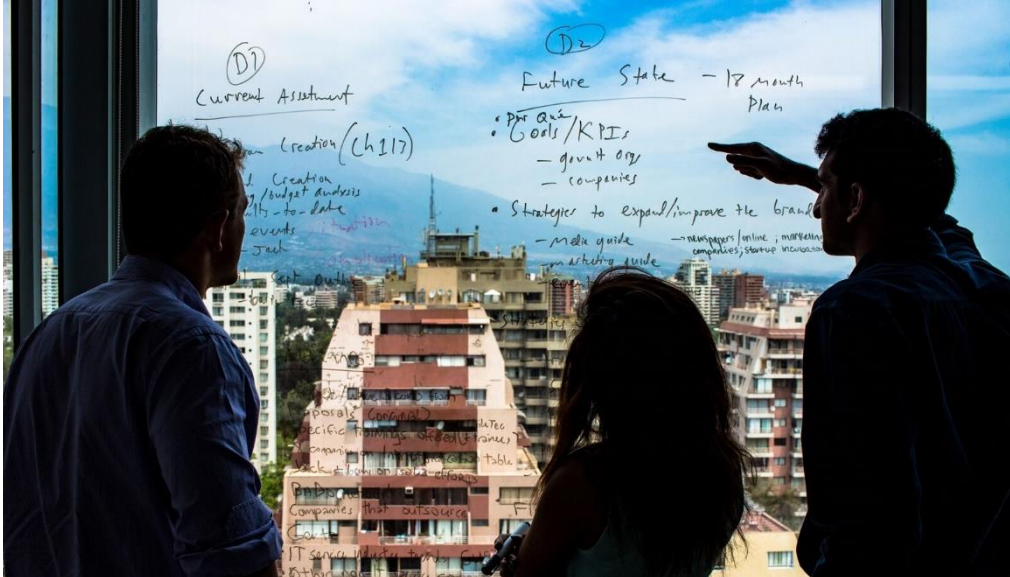

## Sample Project Scopes

- Marketing plan development
- Marketing strategy/analysis
- Industry analysis
- Business development
- Benchmark/Competitive analysis
- Internet-related projects



# 2018-19 MARCH AND MAY SHORT-TERM PROGRAMS INFO SESSIONS

## Manhattan Elective Away

Wednesday, September 5th  
5:00 PM in Trim 201

## Israel Elective Abroad

Monday, September 10th  
4:00 PM in Trim 202

## International Consulting Experience

Tuesday, September 11th  
5:00 PM in Olin 225

## Spain Elective Abroad

Tuesday, September 11th  
6:00 PM in Reynolds 241

## Malaysia / Thailand Elective Abroad

Wednesday, September 12th  
4:00 PM in Trim 202

## Uruguay / Argentina Elective Abroad

Wednesday, September 12th  
5:00 PM in Trim 201

GLAVIN OFFICE  
OF MULTICULTURAL &  
INTERNATIONAL EDUCATION



Initial Applications OPEN:  
Thursday, September 6th  
12:00 PM ET

Initial Applications CLOSE:  
Sunday, September 23rd  
11:59 PM ET

[www.babson.edu/educationabroad](http://www.babson.edu/educationabroad)  
[electivesabroad@babson.edu](mailto:electivesabroad@babson.edu)

GLAVIN OFFICE  
OF MULTICULTURAL &  
INTERNATIONAL EDUCATION

# 2018/19 UG Information Sessions



# BABSON ELECTIVES ABROAD/AWAY

## Pre-Travel

- Academic class sessions
- Glavin Office orientation

## Travel

- 1-3 weeks abroad
- Classes, cultural & company visits

## Post-Travel

- Deliverables due
- Academic class session or consulting project (course dependent)

**NOTE:** All pre-travel, travel, and post-travel dates are mandatory

# SHORT-TERM PROGRAMS TEAM



**Elise Beaudin**  
Director



**Renée Graham**  
Assistant Director



**Alex Nesbeda**  
Program Manager



**Meredith Dziuba**  
Program Assistant



# BABSON ELECTIVES ABROAD/AWAY

Application Process

Important Dates & Deadlines

Financial Considerations

Q&A



# BEFORE YOU APPLY

## Passport

- Check the expiration date (>6 mo. post travel)
- Apply for a (new) passport

## Brochure Page

- Review details on brochure page
- Ensure course fits into your academic plan

## Visas

- Research your visa requirements

## Dates

- Check your calendar
- Discuss travel dates with all 'shareholders'



# WELLNESS ABROAD

Consider your learning style, physical, and mental health needs as you think about the following:

**Course Travel**

**Transitions**

**Deliverables**

**“Me” Time**

# BABSON ELECTIVES ABROAD

## Learning Center

- Submit [Short-Term Program Accommodation Request Form](#)
- Mary Powell, 781-239-5509, [learningcenter@babson.edu](mailto:learningcenter@babson.edu)
- Hollister Hall, First Floor

## Glavin Office

- Renee Graham, [rgraham@babson.edu](mailto:rgraham@babson.edu)
- 781-239-4536
- Hollister Hall, 2<sup>nd</sup> floor

## Wellness Center/ Health Services

- [Health and Wellness Website](#)
- Park Manor South Annex , 781-239-6200
- Hollister Hall, First Floor 781-239-6363

## Physician/Counselor

- Discuss the course requirements/travel with your provider
- Establish/review self care plan



## BABSON ELECTIVES ABROAD

Electives Abroad at Babson are short-term courses that combine classroom instruction on the Babson campus with company site visits, cultural excursions, and hands-on experiences abroad.



Led by Babson faculty, these courses also include in-country lectures given by partner school faculty, distinguished guest speakers. The academic content for these courses is diverse and specialized, ranging from corporate social responsibility in Malaysia to analyzing plays in London to consulting with startups. Elective courses are offered to students during academic breaks in November, January, March, and May.



Course Offerings



Application Process



Policies and Handbooks



Preparing to Go



Coming Home



Information Sessions



FAQs



Financing Your Experience



While Abroad



Resources

[www.babson.edu/ug-bea](http://www.babson.edu/ug-bea)

### Program Description:

Home

Dates

Academics

Logistics

Finances

Contact

Testimonials

## HIS 4610 Social Responsibility in Malaysia & Thailand



James Hoopes, Professor of History  
Murata Professor of Ethics in Business

March Break 2019  
Malaysia & Thailand

Apply Now

# IMPORTANT DATES

|   | <b>Initial Application</b> | <b>Rolling Application</b>                 |
|---|----------------------------|--|
| <b>Application Opens</b>                            | September 6, 2018          | September 27, 2018                         |
| <b>Application Closes</b>                           | September 23, 2018         | November 25, 2018                          |
| <b>Placements Sent</b>                              | September 26, 2018         | Monthly Basis<br>November 28, 2018 (Final) |
| <b>Confirm Placement &amp;<br/>Submit Materials</b> | October 8, 2018            | Monthly Basis<br>December 9, 2018 (Final)  |
| <b>Final Payment DUE</b>                            | <b>December 9, 2018</b>    |  |



# CONFIRM YOUR PLACEMENT

Login to  
[educationabroad.babson.edu](http://educationabroad.babson.edu)

Complete online  
submissions by the  
deadline

Submit \$500 non-  
refundable deposit

## Have ready:

- **Medical Insurance Information**
- **Passport Information & Submission**
- **Visa Requirements**
- **Resume Submission**

# HOW MUCH WILL MY ELECTIVE ABROAD **COST?**

PROGRAM  
FEE

+

BABSON  
TUITION

+

TRAVEL &  
MEALS

-

GRANTS &  
SCHOLARSHIP

**Estimated Total Cost: \$2,600 + Tuition (4 credits)**



# Student Financial Services Frequently Asked Questions

Aimee Yorsaner

Senior Assistant Director, SFS Counselor for  
Students with Last Names H-N

# Costs

| Item   | Amount         | Notes   |
|--|----------------|---|
| <b>Program Fee</b>   | <b>\$2,600</b> | <ul style="list-style-type: none"><li>• Included: Accommodations, breakfast, ground transportation, planned program meals and cultural excursions.</li><li>• Not included: Tuition, additional meals, and personal expenses.</li><li>• Payment: The program fee is paid to the Glavin Office.</li></ul> |
| Babson Tuition   | 4-credits      | <ul style="list-style-type: none"><li>• Included in spring semester flat rate tuition charge (up to 20 credits)</li></ul>   |
| Travel & Meals   | \$500          | <ul style="list-style-type: none"><li>• Estimated Meals: \$250</li><li>• Estimated Incidentals: \$250</li></ul>   |
| Grants & Scholarships                                      |                | Contact SFS for more information  |
| <b>Estimated Total Cost: \$3,100 + Tuition (4 credits)</b> |                |   |



# STUDENT FINANCIAL SERVICES

## Program Fee (Glavin)

- Any deposit to confirm a student's enrollment in the course, as well as the remaining balance of the program fee, is paid directly by the student to the **Glavin Office**.

## Tuition (SFS)

- Tuition is paid directly to **SFS** and is billed at the 2018-2019 credit rate (\$1,597). Each Elective Abroad is 4 credits.

# STUDENT FINANCIAL SERVICES

## Scholarships

- Students who receive a full-tuition scholarship can use a portion of their scholarship to pay for their tuition cost.

## Grants

- Education Abroad Grants in the amount of \$2,000 are awarded to students receiving need-based Babson Grants and full-tuition scholarships (*cumulative limit is \$4,000*).

## Loans

- Students can choose to borrow loans to help cover expenses.

## Your Financial Plans

- To discuss your specific financing plans or budgeting for an Elective Abroad Course, please contact Student Financial Services.



# SFS CONTACTS



**A – G**

Somaly Heang  
sheang@babson.edu



**H – N**

Aimee Yorsaner  
ayorsaner1@babson.edu



**O – Z**

Shannon James  
sjames@babson.edu



**General Inquiries**  
SFS@babson.edu

# ACADEMIC & LOGISTICAL QUESTIONS



## Lead Faculty

- Professor James Hoopes
- 781-239-4345
- [hoopes@babson.edu](mailto:hoopes@babson.edu)



## Course Manager

- Renée Graham
- 781-239-4536
- [rgraham@babson.edu](mailto:rgraham@babson.edu)